

QRS-FW130-01

Plastic Vent Duct penetrating a flexible wall (130mm or thicker)

This standard detail is intended for general information only and all details should be checked against all relevant supporting test evidence, certification and installation guidelines. In line with the company's policy of continual development, details are subject to change and/ or withdrawal therefore you must ensure this is the latest published detail and instructions.

Additional Instructions

Flexible walls to be insulated and to have a minimum 70mm wide stud and minimum 2no. layer of 15mm Gypsum boards in accordance with EN 520 or Calcium Silicate boards which are CE Marked based on an ETA on both sides of the stud.

The board construction should be cut as tight as possible around the QRS Fire Sleeve. The QRS should be fitted so that it is centrally positioned and protruding from or at least flush with the outside of the face of both sides of the wall. Once finally positioned, the small gap around the QRS should be sealed with QuelStop Intumescent Sealant.

If the gap around the QRS exceeds 5mm, then the fire rated board should be replaced in accordance with the board manufacturer's recommendations, or it may be necessary to form a letterbox and complete the seal with QuelStop Fire Batt and Sealant – additional details available upon request.

Test results obtained with flexible supporting walls may be applied to concrete or masonry elements of an overall thickness equal to or greater than that of the element used in the test.

BS EN 1366-3:2021 Section 13.7: The distance between the aperture edges of penetration seals in a building element shall be as tested or minimum 100mm. The distance between the aperture edge of a penetration seal and any other penetration (e.g., door) in a building element shall be minimum 200mm.

Refer to **QRS-FW100-01** for evidence of stacked ducts.

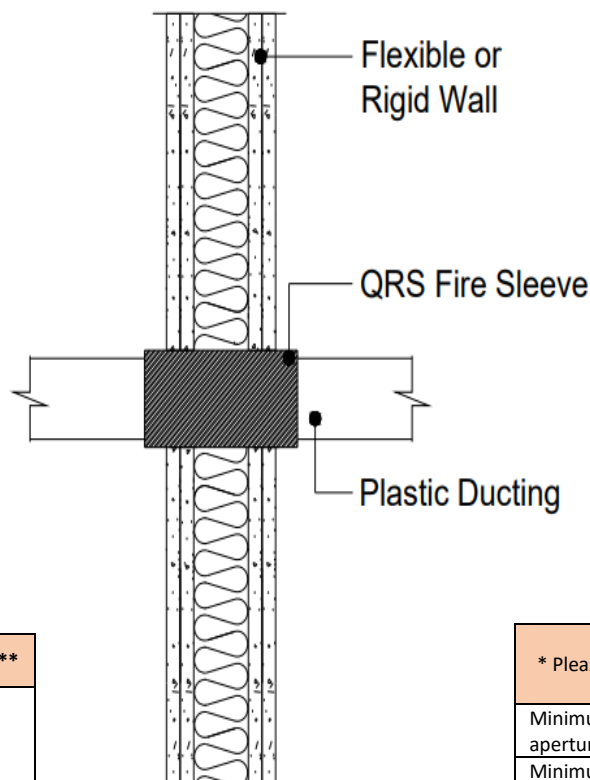

Quelfire Products Required

Product Code	Description
QRS??	Fire Sleeve for plastic ducts. Refer to table below for sizes.
QSS310	QuelStop Intumescent Acrylic Sealant

Service Type	Size of Services	Pipe Wall Thickness	QRS Fire Sleeve	Aperture Size (Approx.)	Classification**
Rectangular U-PVC Duct*	110 x 54mm	1.5mm	QRS110/54	135 x 78mm	EI 120 U/U
	204 x 60 mm		QRS205/60	230 x 85mm	
	220 x 90mm		QRS220/90	262 x 132mm	
	110 x 54mm		QRS110/54SS	126 x 70mm	EI 90 U/U
	204 x 60 mm		QRS204/60SS	219 x 75mm	
Circular U-PVC Duct	220 x 90mm	1.5mm	QRS220/90SS	244 x 114mm	EI 60 U/U
	Ø100mm		QRS110	Ø135mm	EI 120 U/U
PE Corrugated Duct	Ø75mm	Semi Rigid	QRS75	Ø90mm	E 120 U/U EI 90 U/U
	Ø90mm		QRS90	Ø115mm	E 120 U/U EI 45 U/U

* See Section 4.3 of the classification report for comments on 'ducting'.

** Utilising the principles of EN 13502-2: 2016.

Spacing as per BS EN 1366-3: 2021, Section 13.7

* Please also consider any requirements that the wall manufacturer has with regards to spacing between openings.

Minimum distance from edge of opening to another aperture with a service penetration tested to BS EN 1366-3	100mm*
Minimum distance from edge of opening to another aperture with a penetration not tested to BS EN 1366-3	200mm*

To be read in conjunction with:	QRS WF Classification Report 360281/C Issue 3, Page 15 WF Test Report 412164
Test standard:	BS EN1366-3:2009 & EN13501-2:2016
Substrate minimum thickness:	130mm
First service support:	≤250mm
Drawing Scale:	Not to Scale
Issue Number:	3
Date of Issue:	January 2021
Detail Reference:	QRS-FW130-01

Important Information:

- The supporting construction must be installed in accordance with the manufacturer's guidelines and must be capable of achieving the required fire rating of the firestop.
- All Services should be adequately supported either side of the firestop to ensure that no load is transferred onto the firestop seal.

Scope and Liability:

- Any information provided by or on behalf of Quelfire Limited is provided for general information only. It is not intended to amount to advice on which you should rely. You must obtain professional or specialist advice before taking, or refraining from, any recommendation or action.
- The summary is not exhaustive and does not consider all issues relevant to the enquiry. It is limited to the information and time available to us. We have not verified any information made available to us by you or any other source, nor have we carried out a physical inspection of any property. We make no representations, warranties or guarantees, whether expressed or implied, that any information is accurate, complete or up to date.
- We do not accept a duty of care to you or any other person in respect of the enquiry, nor do we accept any liability to you or any other person for any loss arising out of or in connection with the enquiry or any reply provided by us. Different limitations and exclusions of liability arising as a result of the supply of any products or services by us to you, and these will be set out in our terms and conditions of supply, a copy of which is available on request.
- Full terms and conditions of sale are available at <https://www.quelfire.co.uk/terms-conditions-of-sale/>